

August[®]

User Manual

EP616



August International Ltd
United Kingdom
Tel: +44 (0) 845 250 0586
www.augustint.com

- EN Sports Bluetooth Earphones
- FR Écouteurs Bluetooth pour le Sport
- DE Bluetooth Sport Kopfhörer
- IT Auricolari Bluetooth per Sportivi
- ES Auriculares Bluetooth Deportivos

User Manual

Thank you for purchasing the EP616 Sports Bluetooth Earphones. This user manual is designed to familiarize you with all the features of this device. Please take the time to read this user manual carefully, even if you are already familiar with a similar product.

Safety

To ensure the safety of yourself and others, please read the Safety Instructions before using this device. Please do not disassemble the EP616 as it can be unsafe and will invalidate the manufacturer's warranty.

Disposal

Please ensure the product and accessories are disposed of in compliance with the WEEE (Waste Electrical and Electronic Equipment) Directive and any other regulations applicable to your country. Always check with the environment agency and any other relevant authorities for current disposal regulations.

Declaration of Conformity

The Declaration of Conformity can be found on our website at <http://augustint.com/en/declaration/>

Customer Service

You can contact: +44 (0) 845 250 0586 or email service@augustint.com should you require technical support and customer service.

1. Safety Instructions

■ Storage and Use

	Do not store or use this device in extreme temperatures.		Do not store or use this device in wet or damp environments.
	Do not expose this device to dust, oil or smoke.		Do not drop or strike this device.
	When transporting this device, store securely to avoid impact damage.		Do not scratch this device with sharp objects.

■ Maintenance

Please unplug all leads before cleaning this device.

	Wipe the device and buttons with a soft cloth.		Never wipe this device with an abrasive cloth or apply detergent, alcohol or chemical based cleaning products.
--	--	--	--

■ Warning:

1. Listening to headphones or earphones at high volume for prolonged periods can cause damage to your hearing.
2. Please be considerate to others and listen at a low volume while in public.
3. If you are experiencing tinnitus, stop using headphones or listen only at a very low volume.

2. Main Features

- Wireless Earphones for Bluetooth Devices
- Integrated Microphone for Hands-Free Calls
- Bluetooth v4.1 and aptX for Enhanced Sound Quality
- Built-in Rechargeable Battery

3. Box Contents



EP616



Power Cable



User Manual



Ear Buds



Carry Bag

4. Part Names and Functions

4.1 Device Layout

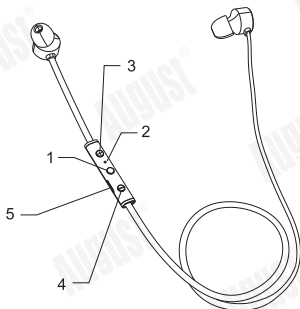

1. Power / Play / Pause / Answer
2. Status LED / Microphone
3. Next Track / Volume Up
4. Previous Track / Volume Down
5. Charging Socket

4.2 Remote Control

Button	Operation	Function
+	Press	Next Track
+	Press and hold	Volume Up
-	Press	Previous Track
-	Press and hold	Volume Down
Power	Press	Play / Pause; Pick up / Hang up a call
Power	Press and hold	Power on / Power off; Reject an incoming call

4.3 Status LED Meaning

Indication	LED Status
Pairing	Flashing Red and Blue
Paired	Flashing Blue
Low Battery	Flashing Red
Charging	Red
Fully Charged	Blue

5. Operation

5.1 Power

Please fully charge the EP616 before the first use or if left unused for a long period of time. To charge, use the power cable to connect the earphones to a powered USB port.

The status LED will light red while charging and will turn to blue once fully charged. Ensure that the output voltage from the USB port or the charger is 5V.

5.2 Turn On / Off

Press and hold the Power button for 3 seconds to switch on the EP616. The EP616 will enter reconnection mode and the status LED will flash red.

Press and hold the Power button for 3 seconds to switch off the EP616.

If there is no Bluetooth connection, the EP616 will turn off automatically after 10 minutes.

5.3 Bluetooth Connection

When the EP616 is switched on, it will enter reconnection mode and connect automatically to any previously known device. If no previously connected devices are found, the EP616 will enter pairing mode after 3 seconds.

To connect to a different device, turn off the EP616 first, then press and hold the Power button for 5 seconds to enter pairing mode.

In pairing mode, the status LED will flash red and blue.

To forget all previously paired devices, while the EP616 is in pairing mode, press and hold **+** and **-** together for 6 seconds.

- For mobile phones and tablets

1. Scan for available Bluetooth devices on your mobile phone or tablet.
(Please consult the device's user manual for further instructions if necessary.)
2. Select 'EP616' from the available devices and confirm the connection. Some devices require a pin code. If this is the case, please enter the code '0000'.
3. Once successfully connected, the status LED will flash blue.

- For computers

1. Enable the Bluetooth function on your computer.
2. Select 'Device and Printers' from the Control Panel and click 'Add a Device'.
3. Select 'EP616' from the available devices. The computer will automatically install the driver. If a pin code is requested, please enter the code '0000'.
4. Once successfully connected, the status LED will flash blue.

5.4 Multipoint

Multipoint allows you to connect your EP616 headphones to two source devices at the same time.

- To create a multipoint connection:

1. Turn off the EP616 and all source devices.
2. Press and hold the Power button for 5 seconds to turn on the EP616 and put it into pairing mode. In pairing mode the status LED will flash red and blue.
3. Press the power button to enable multipoint.
4. Pair the EP616 to the first source device.
5. Turn off the Bluetooth on the first source device.
6. Pair the EP616 to the second source device.
7. Turn on the Bluetooth on the first source device. The EP616 will automatically reconnect to the first source device.

- To disable the Multipoint function on the EP616:

1. Turn off the EP616 and all source devices.
2. Press and hold the Power button for 5 seconds to turn on the EP616 and put it into pairing mode. In pairing mode the status LED will flash red and blue.
3. Double press the power button to disable the multipoint.

6. Charging

Connect the EP616 to a powered USB port using the provided USB charging cable. While charging, the status LED will light red. It will turn blue once the battery is fully charged.

A full charge takes approximately 1.5 hours depending on power input.

Note:

- 1) Ensure that the output voltage from the USB port or the charger is 5V. Charging voltage greater than 5V may damage the headphones.
- 2) Please fully charge the EP616 before first use or if left unused for a long period of time.

If you are using a smart USB charger, use the common USB port and ensure that the output voltage is 5V.

7. Specification

Bluetooth Version	v4.1 with aptX
Bluetooth Distance	10m
Transmission Frequency	2.40GHz-2.48GHz
Support Profile	HSP/HFP/A2DP/AVRCP
Speaker Diameter	Ø6mm
Impedance	16Ω
Sensitivity	86+/- 3dB
Speaker Output	3mW x 2
Frequency Response	120Hz-20KHz
Signal and Noise Ratio(SNR)	≥80dB
Distortion	≤3%
Battery Type	3.7V/110mAh Built-in Li-Polyme Battery
Charging Time	1.5Hours
Continuous working time	7 hours
Standby Time	18days
Dimensions	550 × 26 × 12mm
Net Weight	10g

8. Troubleshooting

Problem	Solution
Won't turn on.	• Please ensure that the EP616 is charged.
Can't find the EP616.	• Confirm that the EP616 is in pairing mode and within 10 meters of the device.
Can't install the driver for EP616 on a computer.	• Update the driver of the Bluetooth module on your computer.
The sound quality is intermittent in Bluetooth mode.	• Disable the Wi-Fi on your source device.
No sound.	• Check the volume on both the source device and the EP616.

9. Warranty

This product is guaranteed for twelve months from the date of the original purchase. In the unlikely event of any defect arising due to faulty materials or workmanship, the unit will be either replaced or repaired free of charge (where possible) during this period. An alternative product will be offered in case the product is no longer available or repairable.

This warranty is subject to the following conditions:

- The warranty is only valid within the country where the product is purchased.
- The product must be correctly installed and operated in accordance to the instructions given in this user manual.

- The product must be used solely for domestic purposes.
- The warranty only covers the main units, and does not cover the accessories.
- The warranty does not cover the damage caused by misuse, negligence, accident and natural disaster.
- The warranty will be rendered invalid if the product is resold or has been damaged by inexperienced repairs. The manufacturer disclaims any liability for incidental or consequential damages.
- Please consult our customer adviser before returning any product; we are not responsible for any unexpected product returns.
- Any faulty product must be kept and returned in the original packaging with all the accessories and the original copy of the purchase receipt.

The warranty is in addition to, and does not diminish, your statutory or legal rights.

Customer Service:

Telephone: +44 (0) 845 250 0586

Email: service@augustint.com

This product is in compliance with the essential requirements and other relevant provisions of Directive 2014/53/EU. The Declaration of conformity may be consulted online at <http://www.augustint.com/en/declaration>.

